

ORDINANCE 2015-2

AN ORDINANCE ANNEXING CERTAIN REAL PROPERTY OWNED BY  
ROBERT L. KRAUSE, JR., INTO THE MUNICIPAL LIMITS OF THE  
TOWN OF ST. LUCIE VILLAGE, FLORIDA.

---

WHEREAS, Robert L. Krause, Jr., is the owner of a tract of land described in attached Exhibit "A", which property is in the unincorporated area of St. Lucie County but contiguous to the Town of St. Lucie Village, Florida and reasonably compact; and

WHEREAS, Robert L. Krause, Jr., has petitioned the Board of Aldermen to have the property annexed into the Town of St. Lucie Village, Florida and annexation would not create enclaves; and

WHEREAS, §171.044, Fla. Stat., specifies the procedure for voluntary annexation of real property into a municipality; and

WHEREAS, the terms and provisions of §171.044, Fla. Stat., have been met, including publication of notice and providing a copy of this Ordinance, via certified mail return receipt requested, to the St. Lucie County Board of County Commissioners.

NOW, THEREFORE, the Board of Aldermen of the Town of St. Lucie Village, Florida hereby ordains:

1. The above described land, which is more particularly described in Exhibit "A" attached hereto and incorporated herein, is hereby added to, taken into, made a part of, and annexed into the municipal limits of the Town of St. Lucie Village, Florida, and the municipal limits thereby redefined to include said property, the correct legal description of which is encompassed in attached Exhibit "A". A map depicting said property is also attached as Exhibit "B". A complete legal description by metes and bounds is attached as Exhibit "C".

2. Said property is deemed to fall within the current R-1 residential zoning.

3. A copy of this Ordinance shall be filed with the Clerk of the Circuit Court of the St. Lucie County, the Chief Administrative Officer of St. Lucie County, and the Department of State within seven (7) days after adoption of the Ordinance.

4. This Ordinance shall become effective upon passage.

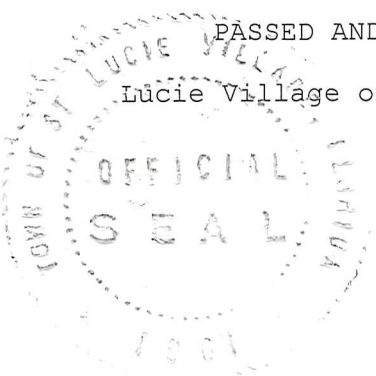

PASSED AND APPROVED by the Board of Aldermen of the Town of St. Lucie Village on this 21<sup>st</sup> day of April, 2015.

APPROVED:  
BOARD OF ALDERMEN OF THE TOWN OF  
ST. LUCIE VILLAGE, FLORIDA

By: William G. Thiess  
William G. Thiess, Mayor

ATTESTED:  
By: Diane C. Orme  
Diane C. Orme, Clerk

I, DIANE C. ORME, Clerk of the TOWN OF ST. LUCIE VILLAGE, FLORIDA, do hereby certify that this is a true and accurate copy of Ordinance **2015-2** which was duly introduced, read and adopted at the regular meeting of the Board of Aldermen of the TOWN OF ST. LUCIE VILLAGE, FLORIDA, held this 21<sup>st</sup> day of April, 2015.

Diane C. Orme  
DIANE C. ORME, CLERK

EXHIBIT "A"

Return to: (enclose self-addressed stamped envelope)

Name: CH BX 76  
Treasure Coast Abstract & Title Ins. Co.  
Address: 401B So. Indian River Dr.  
Ft. Pierce, FL 34950  
File no. 58792

This instrument prepared by:  
Frank H. Fee, III, Esquire  
Address: Fee, Bryan & Koblegard PA  
P.O. Box 1000  
Ft. Pierce, FL 34954

Property Appraisers Parcel Identification (Folio) Number(s):  
1433-110-0020-000/7 and 1433-501-0013-  
Grantee(s) S.S. #(s): 010/8

QUIT-CLAIM DEED

RAMCO FORM 8

STATE OF FLORIDA  
ST. LUCIE COUNTY

THIS IS TO CERTIFY THAT THIS IS A  
TRUE AND CORRECT COPY OF THE  
ORIGINAL

*[Signature]*  
Deputy Clerk  
Date: FEB 02 2015



SPACE ABOVE THIS LINE FOR PROCESSING DATA

SPACE ABOVE THIS LINE FOR RECORDING DATA

This Quit-Claim Deed, Executed this 1st day of May, A.D. 19 95, by  
ROBERT L. KRAUSE, SR., a single adult, the surviving spouse of Henrietta F.  
Krause, deceased  
first party, to ROBERT L. KRAUSE, JR.

whose post office address is Rt. 1, Box 181, German Blvd., Yaphank, NY 11980

second party:

(Whereas used herein the terms "first party" and "second party" shall include singular and plural, being, legal representatives, and assigns of individuals, and the successors and assigns of corporations, wherever the context so admits or requires.)

Witnesseth, That the said first party, for and in consideration of the sum of \$ 10.00  
in hand paid by the said second party, the receipt whereof is hereby acknowledged, does hereby remise, release and  
quit-claim unto the said second party forever, all the right, title, interest, claim and demand which the said first  
party has in and to the following described lot, piece or parcel of land, situate, lying and being in the County of  
St. Lucie, State of Florida to-wit:

Beginning at a point on the Northeast corner of Lot 15, Block A, M.D. HUNT SUBDIVISION,  
as per plat thereof, recorded in Plat Book 9, page 47, of the Public Records of St.  
Lucie County, Florida; thence run South along the East boundary line of said Lot 15 to  
the Southeast corner of said Lot 15; thence turn on an angle of 90° and run East to the  
West right-of-way line of State Road 605; thence turn and run Northwesterly along the  
West right-of-way line of State Road 605 to a point of the intersection of said West  
right-of-way line and a line projected and extended due East of the North line of said  
Lot 15; thence turn due West and run along said extended line to the POINT OF BEGINNING  
AND  
Lot 15, less the West 40 feet thereof, Block A, M. D. HUNT SUBDIVISION, according to  
the Plat thereof, as recorded in Plat Book 9, page 47, of the Public Records of St.  
Lucie County, Florida.

TITLE TO SUBJECT PROPERTY HAS NOT BEEN EXAMINED BY THE SCRIVINER.

THE GRANTOR HEREIN covenants that he is the unmarried surviving spouse of Henrietta\*

To Have and to Hold The same together with all and singular the appurtenances thereunto belonging  
or in anywise appertaining, and all the estate, right, title, interest, lien, equity and claim whatsoever of the said  
first party, either in law or equity, to the only proper use, benefit and behoof of the said second party forever.

In Witness Whereof, The said first party has signed and sealed these presents the day and year first  
above written, \*F. Krause, deceased, and that they were continuously married, without  
interruption from the time they took title to subject property until the date of her  
Signed, sealed and delivered in the presence of: demise.

*[Signature]*  
Witness Signature (as to first Grantor)

Brenda J. Bidle  
Printed Name

*[Signature]*  
Witness Signature (as to first Grantor)

Linda F. Miller  
Printed Name

Witness Signature (as to Co-Grantor, if any)

Printed Name

Witness Signature (as to Co-Grantor, if any)

Printed Name

STATE OF Florida )  
COUNTY OF St. Lucie )

Robert L. Krause, Sr., a single adult, the surviving spouse of Henrietta F. Krause,  
known to me to be the person described in and who executed the foregoing instrument, who acknowledged before me that he  
executed the same, that I relied upon the following form of identification of the above-named person : deceased  
Georgia DL#019537256 and that an oath (was)(was not) taken.

NOTARY RUBBER STAMP SEAL

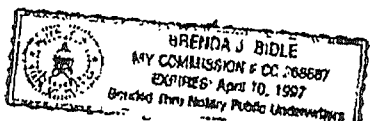

*[Signature]*  
Grantor Signature

Robert L. Krause, Sr.  
Printed Name

P.O. Box 70  
Post Office Address

Waynesville, Georgia 31566

Co-Grantor Signature (if any)

Printed Name

Post Office Address

Witness my hand and official seal in the County and State last aforesaid this  
1st day of May, A.D. 19 95

*[Signature]*  
Notary Signature

Brenda J. Bidle  
Printed Notary Signature

0.00  
0.70  
0.00  
\* Doc Assump: \$  
\* Doc Tax : \$  
\* Int Tax : \$

Johnnie Holman, Clerk of the Circuit Court - St. Lucie County  
File Number: 1399224 OR BOOK 0957 PAGE 0830  
Recorded: 05-23-95 03:55 P.M.

EXHIBIT "B"

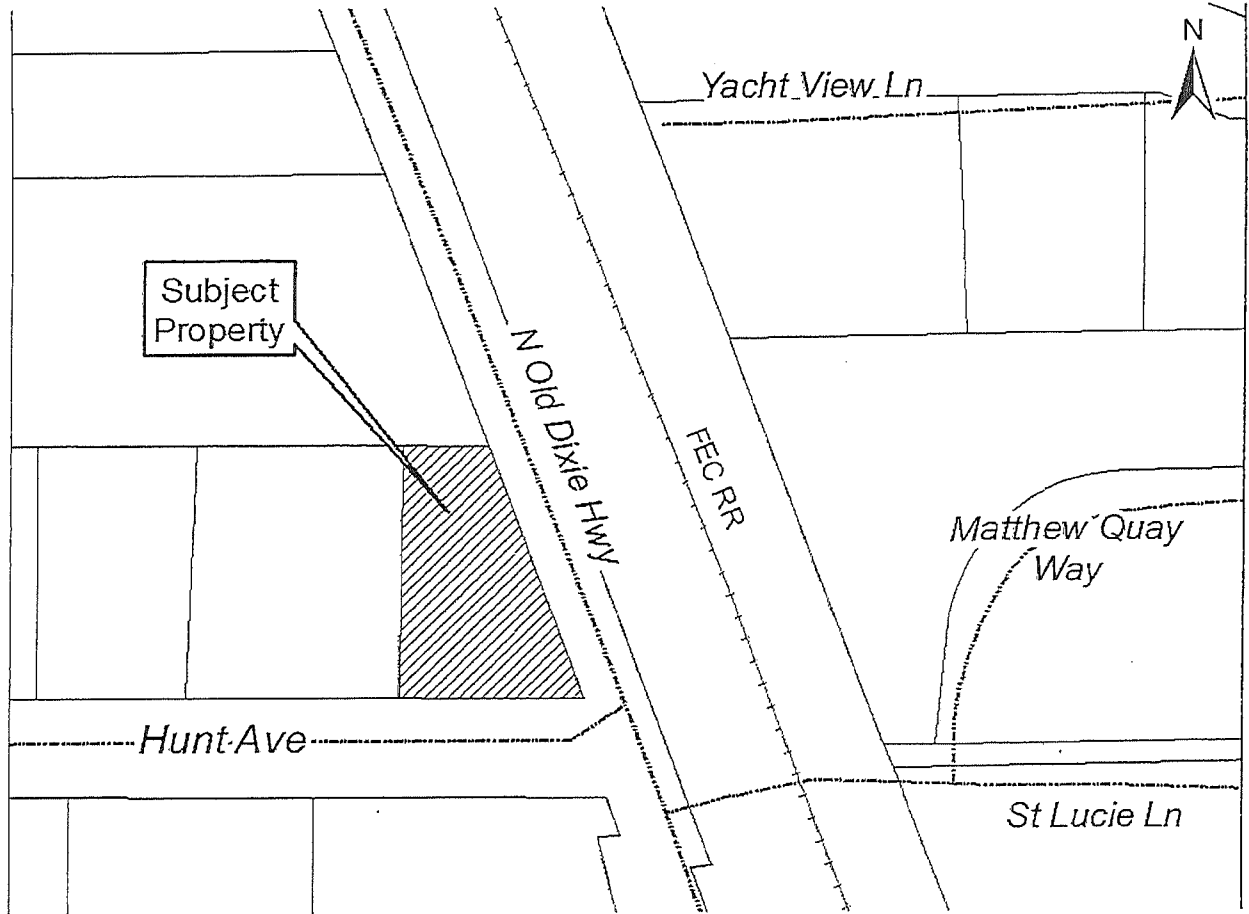

EXHIBIT "C"

Legal description by metes and bounds:

Property located in St. Lucie County, Florida, described as follows:

Beginning at a point on the Northeast corner of Lot 15, Block A, M.D. HUNT SUBDIVISION, as per plat thereof, recorded in Plat Book 9, page 47, of the Public Records of St. Lucie County, Florida; thence run South along the East boundary line of said Lot 15 to the Southeast corner of said Lot 15; thence turn on an angle of 90° and run East to the West right-of-way line of State Road 605; thence turn and run Northwesterly along the West right-of-way line of State Road 605 to a point of the intersection of said West right-of-way line and a line projected and extended due East of the North line of said Lot 15; thence turn due West and run along said extended line to the POINT OF BEGINNING.

AND

Beginning at a point on the Northeast corner of Lot 15, Block A, M.D. HUNT SUBDIVISION, as per plat thereof, recorded in Plat Book 9, page 47, of the Public Records of St. Lucie County, Florida; thence run West along the North boundary of said Lot 15 to a point 40 feet West from the Northeast corner of Lot 15; thence run South approximately 129.11 feet to a point on the South boundary of said Lot 15 being 40 feet West of the Southeast corner of said lot; thence proceed East to the Southeast corner of said Lot 15; thence proceed North along the East boundary of said Lot 15 to the Northeast corner of the lot and the POINT OF BEGINNING.